

## S6 SERIES 15 W

- Motor speed < 2000rpm, hence silent operation
- Guaranteed life time 2000hrs
- Different shafts available
- Also customised motors

### MOTOR DIMENSIONS

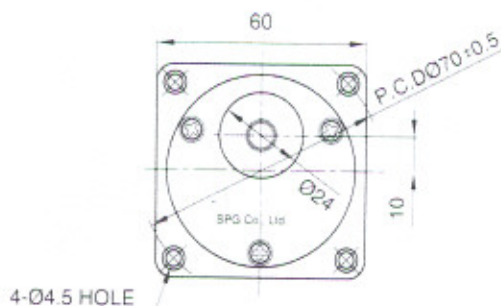
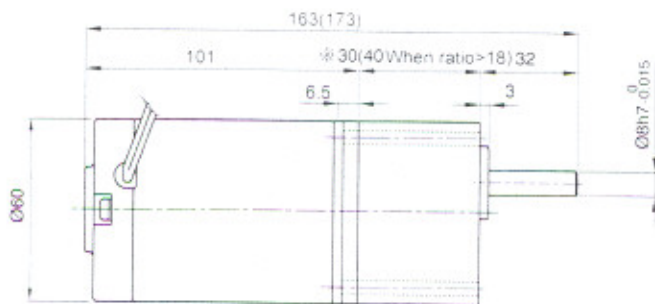

### CHARACTERISTIC CURVE

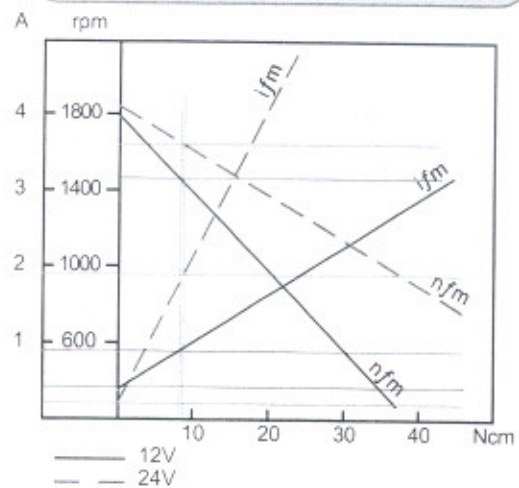

### SHAFT DIMENSIONS

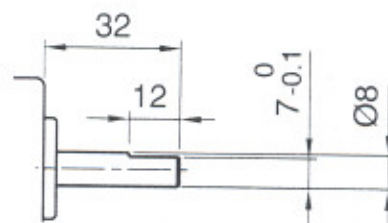

Stock type. Other shafts on request.

### GEAR HEAD RATED LOAD

All numbers are according to S6D15-24A-18 and they are slightly different with 12V version

GEAR RATIO	3	3,6	5	6	7,5	9	10	12,5	15	18	20	25	30	36	40	50	60	75	90	100	120	150	180	200
MODEL rpm	550	458	330	275	220	183	165	132	110	92	83	66	55	46	41	33	28	22	18	17	14	11	9	8
S6DA□B Nm	0,21	0,25	0,35	0,42	0,53	0,64	0,71	0,88	1,06	1,27	1,27	1,59	1,91	2,29	2,54	2,87	2,94	2,94	2,94	2,94	2,94	2,94	2,94	2,94
Type	Supply	Speed		Current		Rated	Weight																	
	voltage	No-load	Rated	No-Load	Rated	Torque																		
S6D15-12A-18	12Vdc	1800	1470	0,4A	1,9A	9,8 Ncm	0,9 kg																	
S6D15-24A-18	24Vdc	1850	1650	0,2A	0,9A	8,7 Ncm	0,9 kg																	